

**NOTES ON FINISHES:**

- ROOF : TO BE FINISHED IN SLATE OR CONCRETE ROOF TILES IN SELECTED COLOUR OR SIMILAR APPROVED.
- WALLS : SELECTED CLAY BRICKWORK WHERE INDICATED OTHERWISE PAINTED SAND / CEMENT RENDER OR SELF COLOURED RENDER. EXPRESSED BANDS AROUND EXTERNAL OPES/EXPRESSED LINTELS OVER EXTERNAL OPES WHERE INDICATED TO BE RECONSTITUTED STONE (LIGHT CREAM LIMESTONE OR GRANITE EFFECT)
- JOINERY : ALL WINDOWS AND DOORS, FRAMES AND LEAVES, TO BE ALUMINIUM POWDER-COATED TO APPROVED COLOUR OR uPVC OR PAINTED TIMBER TO APPROVED COLOUR. OBSCURE GLAZING WHERE INDICATED TO SENSITIVE WINDOWS.
- BALCONIES : GLAZED BALCONIES WITH POWDER COATED HANDRAILS.
- RAINWATER GOODS : GUTTERS, DOWNPIPES, AND FIXINGS TO BE uPVC OR ALUMINIUM POWDER COATED TO SELECTED COLOUR TO MATCH ROOF SLATES

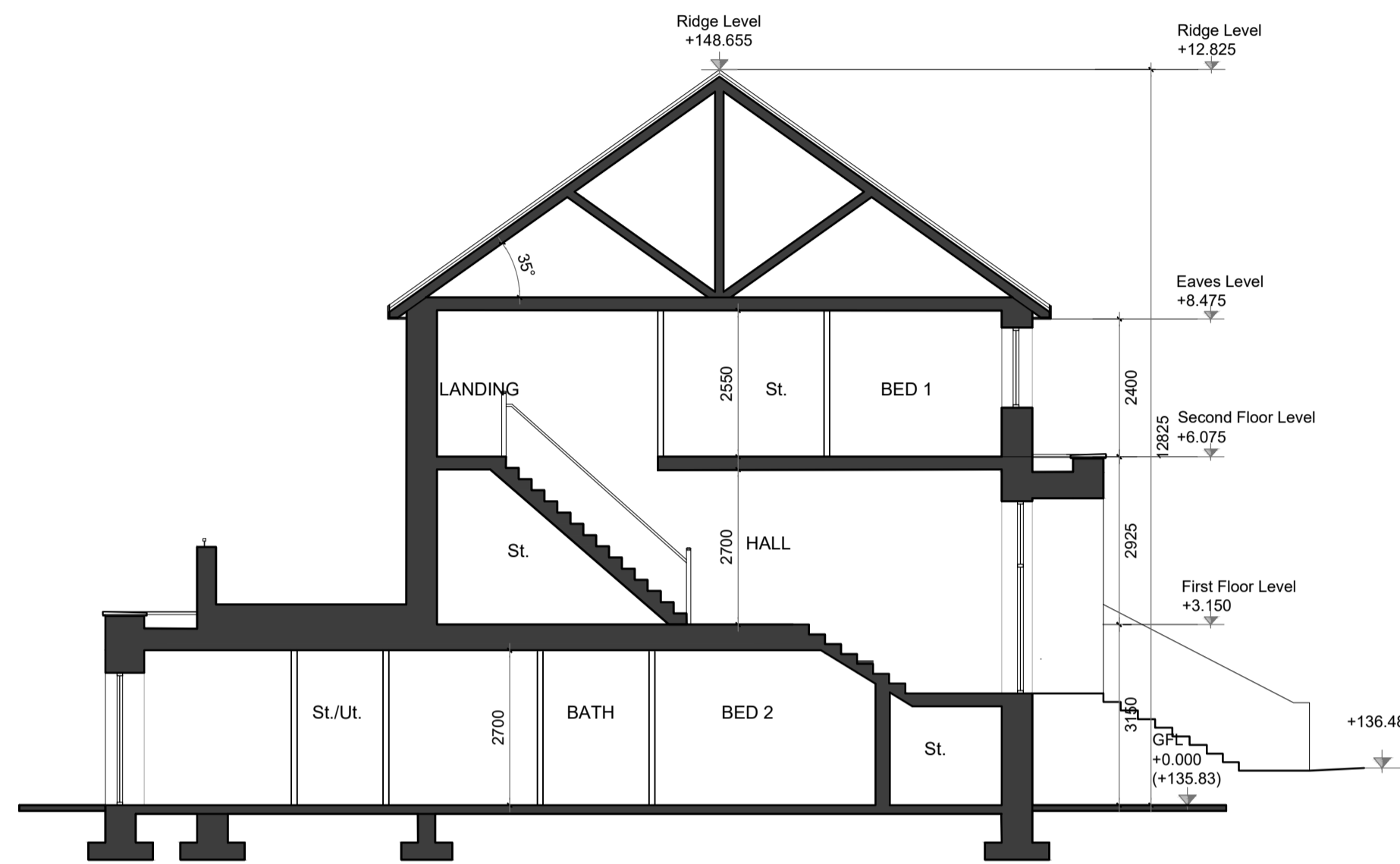

SECTION A-A

Indicative solar panel position, final solar panel quantity & position subject to detailed design, on duplex block orientation and final BER requirement at the time of publication. The solar panels shown are a provisional option to satisfy renewable energy requirements of building regs part L. Solar panels may be omitted in favour of alternative renewable energy source.



WEST ELEVATION B

**NOTES:**

DO NOT SCALE FROM DRAWINGS. WORK TO FIGURED DIMENSIONS ONLY. ARCHITECT TO BE NOTIFIED OF ALL DISCREPANCIES.

REVISIONS		
DATE	DESCRIPTION	No.

MCM

PROJECT TITLE: Residential Development @ Boherboy Lands  
 DRAWING TITLE: Duplex Block C Elevations & Section  
 1 Grantham Street, Dublin 8, D08 A49Y, Ireland.  
 Tel: 01-4788700 Fax: 01-4788711 E-Mail: arch@mcm.ie

DATE: Jun '21  
 DRAWN BY: SM  
 SCALE: 1:100  
 JOB NO: 20002  
 DRAWING NO: DUPC05